

# Modulating Water Valves and Bulb Wells

0617

**APPLICATION:** These modulating valves regulate the flow of water to the heat exchanger to maintain a desired exiting oil temperature. They open automatically when temperature increases at the sensing bulb. **No** external power source is required to actuate the valve. **Not to be** used for salt water service.

**ADJUSTMENT:** ½" to 1¼" valves can be adjusted with a screwdriver, 1½" and 2½" have a ½" square shaft. Turn the adjusting screw clockwise to **decrease** opening temperature; and counterclockwise to **increase** opening temperature. Valves are not calibrated, so final desired temperature setting must be established experimentally. Valve is fully open 36°F above opening point.

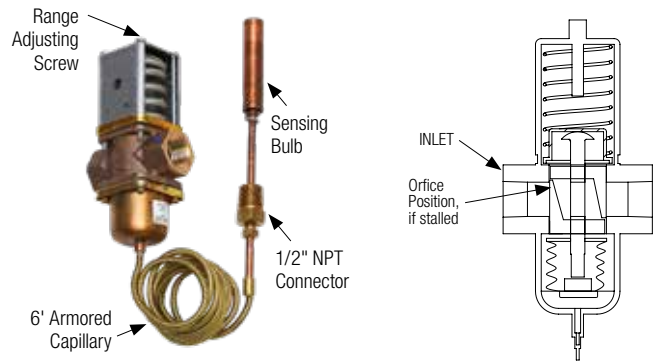

Part Number	Water Valves				Bulb Well Recommended Size
	Pipe Size (NPT)	Range (Opening Point)	Sensing Bulb Size Diameter X Length	Maximum Water Flow	
65293	½"	115°F to 180°F	11/16" x 3¼"	25 GPM	65140
65127	¾"	115°F to 180°F	11/16" x 3¼"	40 GPM	65140
65128	1"	115°F to 180°F	11/16" x 6"	55 GPM	65141
65146	1¼"	115°F to 180°F	11/16" x 6"	75 GPM	65141
65511	½"	75°F to 135°F	11/16" x 10"	25 GPM	65280
65253	¾"	75°F to 135°F	11/16" x 10"	40 GPM	65280
65254	1"	75°F to 135°F	11/16" x 16¼"	55 GPM	67438
65255	1¼"	75°F to 135°F	11/16" x 16¼"	75 GPM	67438
66100	1½" ASME	75°F to 135°F	11/16" x 16¼"	90 GPM	67438
59417	2½" ASME	75°F to 115°F	11/16" x 43"	250 GPM	67808

Working pressure to 150 PSI Maximum. \*For additional protection of the bulb well stem, use the next longer bulb well.

## Water Valves

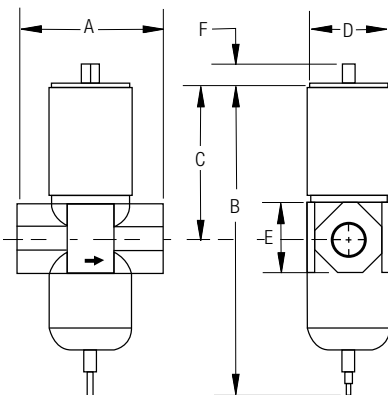

Valve Size	Dimensions (Inches)						Approximate Shipping Weight (LBS)
	A	B	C	D	E	F	
1/2"	¾	7	¾	1 <sup>27</sup> / <sub>32</sub>	1½	1 <sup>1</sup> / <sub>2</sub>	4.3
3/4"	3 <sup>1</sup> / <sub>16</sub>	7 <sup>29</sup> / <sub>64</sub>	3 <sup>5</sup> / <sub>64</sub>	2 <sup>1</sup> / <sub>32</sub>	1¾	1 <sup>3</sup> / <sub>32</sub>	5.8
1"	4 <sup>27</sup> / <sub>32</sub>	10 <sup>13</sup> / <sub>16</sub>	5 <sup>3</sup> / <sub>64</sub>	2 <sup>5</sup> / <sub>8</sub>	2	½	10
1-1/4"	4 <sup>59</sup> / <sub>64</sub>	10 <sup>37</sup> / <sub>64</sub>	5 <sup>43</sup> / <sub>64</sub>	2 <sup>5</sup> / <sub>8</sub>	2 <sup>3</sup> / <sub>8</sub>	½	12
1-1/2"	5 <sup>7</sup> / <sub>16</sub>	10 <sup>37</sup> / <sub>64</sub>	5 <sup>43</sup> / <sub>64</sub>	2 <sup>5</sup> / <sub>8</sub>	See Flange below	½	18
2½"	6¾	12 <sup>33</sup> / <sub>64</sub>	6 <sup>15</sup> / <sub>32</sub>	3½		½	31

Valve Size	Flange Specifications (Inches)			
	Number of Bolt Holes	Bolt Hole size	Bolt Circle	Flange Diameter
1/2"	4	5/8	3 3/8	5
2½"	4	¾	5 ½	7

Standard temperature elements are furnished with 6' capillary. Longer capillary lengths not available. Valve Disc: Buna N in brass disc retainer.